

Bayou La Batre 4 Mile Course

Bayou La Batre, AL

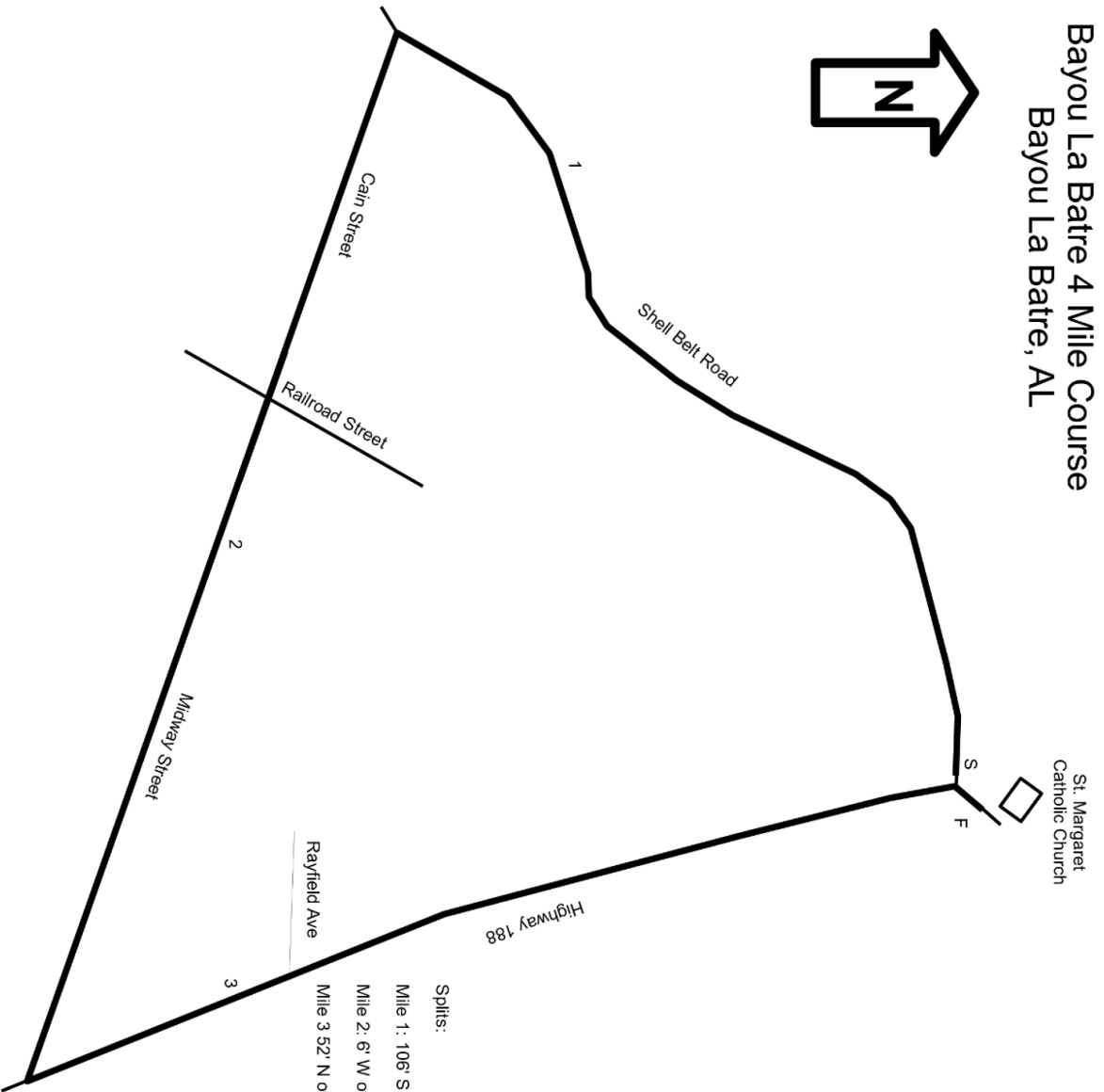
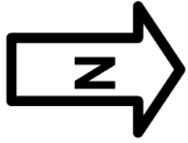

Course was measured on the SPR and the runners have full use of the road unless otherwise noted.

Diagrams to scale
Start and Finish marked with paint and washers
Splits: Marked with paint and washers.

- Splits:
- Mile 1: 106' S of pole 5-138940 on E; marked on W, opposite house 14181 on E
 - Mile 2: 6' W of pole 5-139875 Marked on N
 - Mile 3 52' N of fire hydrant on E; in front of house 8565 Marked on W

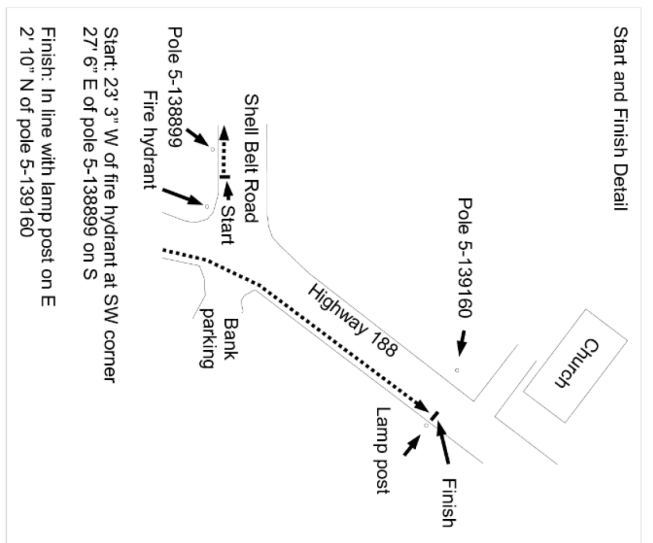

USATF Certificate
AL22052JE
Effective: 12/02/2022
Through: 12/31/2032

Measured by Jon Bowie (Daphne, AL 251-209-0887)
jnbowie@gmail.com 02 December 2022